



## PARTICIPATING FACULTY in CMM/BLL Lobby - LOWER LEVEL

1. START HERE: INFORMATION TABLE
2. UG BIO - Drs. Medina & O'Neal
3. SARAS - Dr. Pentyala and  
SOM - Drs. Benveniste, Dilger, Du, Liu, Pentyala, Rampil  
& Rebecchi
4. SoMAS - Dr. Munch
5. SoMAS - Dr. Cerrato (Pan)
6. E&E - Dr. Pigliucci (Jonas) & Dr. Wright (Monzon)
7. E&E - Drs. Gurevitch & Lowry
8. E&E - Dr. Rest
9. TBD
10. E&E - Dr. Baines
11. E&E - Dr. Graham
12. E&E - Dr. Padilla & FERTL
13. E&E - Dr. Padilla & FERTL
14. E&E - Dr. Akcakaya
15. PHARM - Dr. Garcia-Diaz
16. BME - Dr. Frame
17. BME & TISSUE ENGINEERING - Dr. Clark
18. BCH - Dr. Smith
19. BNL - Dr. Thanos
20. BCH - Dr. Dean
21. BCH - Dr. Haltiwanger
22. SOM - Dr. Zieve
23. SOM - Drs. Shroyer & Ju
24. SOM - Drs. Shroyer & Ju
25. NEURO - Dr. McKinnon
26. NEURO - Dr. Kernan
27. NEURO - Dr. Kritzer
28. ANAT SCI - Dr. Krause
29. BCH - Dr. Holdener

PLEASE SEE BACK OF THIS PAGE FOR PARTICIPANTS ON  
CMM/BLL LOBBY - UPPER LEVEL

## UG BIO Research Open House

WEDNESDAY, NOVEMBER 4, 2009, 12 - 2 PM  
CMM/BLL LOBBY LOWER & UPPER LEVEL

## CMM/BLL LOBBY - LOWER LEVEL

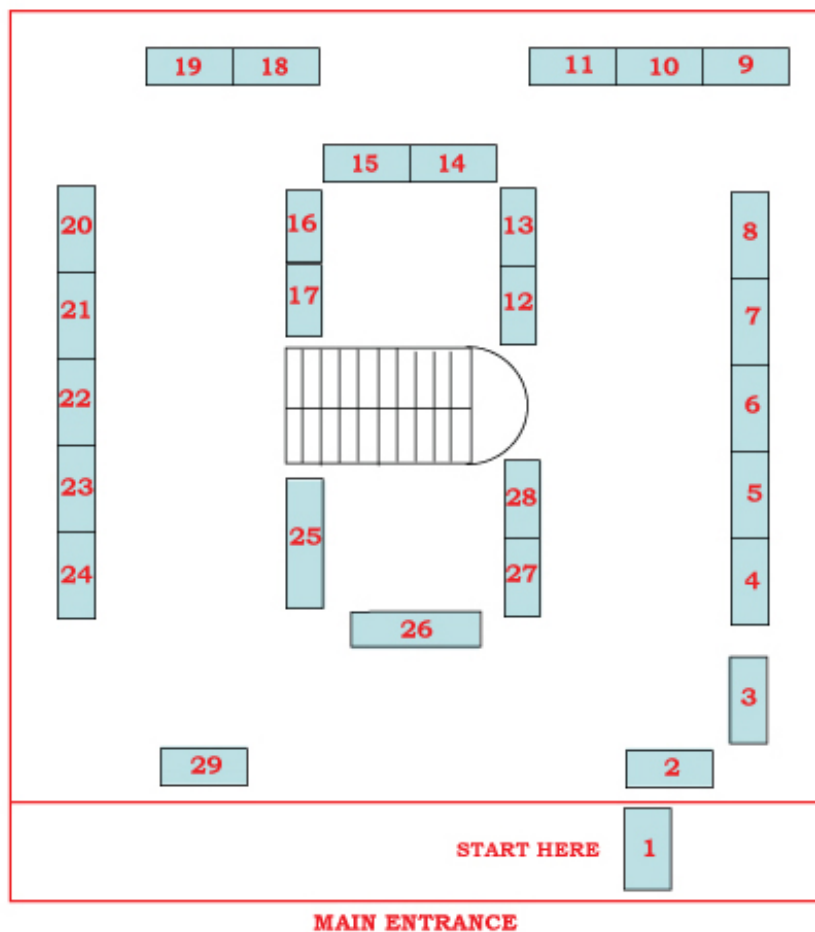



## PARTICIPATING FACULTY in CMM/BLL Lobby - UPPER LEVEL

30. COOKIES and CANDY for all
31. CENTER FOR INCLUSIVE EDUCATION - Valdez-Wochinger
32. MEDICAL SCIENTIST TRAINING PROGRAM - Kaufman
33. SCIENCE EDUCATION PROGRAM - Dr. Padwa
34. ICTE (Madagascar) - King
35. URECA - Kernan
36. CAREER CENTER - Dr. James
37. OFFICE OF DENTAL RESEARCH - Dr. Moonga
38. TBD
39. TBD
40. TBD
41. TOWN OF HEMPSTEAD - Brown
42. NORTH SHORE UNIV HOSP EMERGENCY MEDICINE - Hanh & Tan
43. NORTH SHORE UNIV HOSP EMERGENCY MEDICINE - Hanh & Tan

## UG BIO Research Open House

WEDNESDAY, NOVEMBER 4, 2009, 12 - 2 PM  
CMM/BLL LOBBY LOWER & UPPER LEVEL

## CMM/BLL LOBBY - UPPER LEVEL

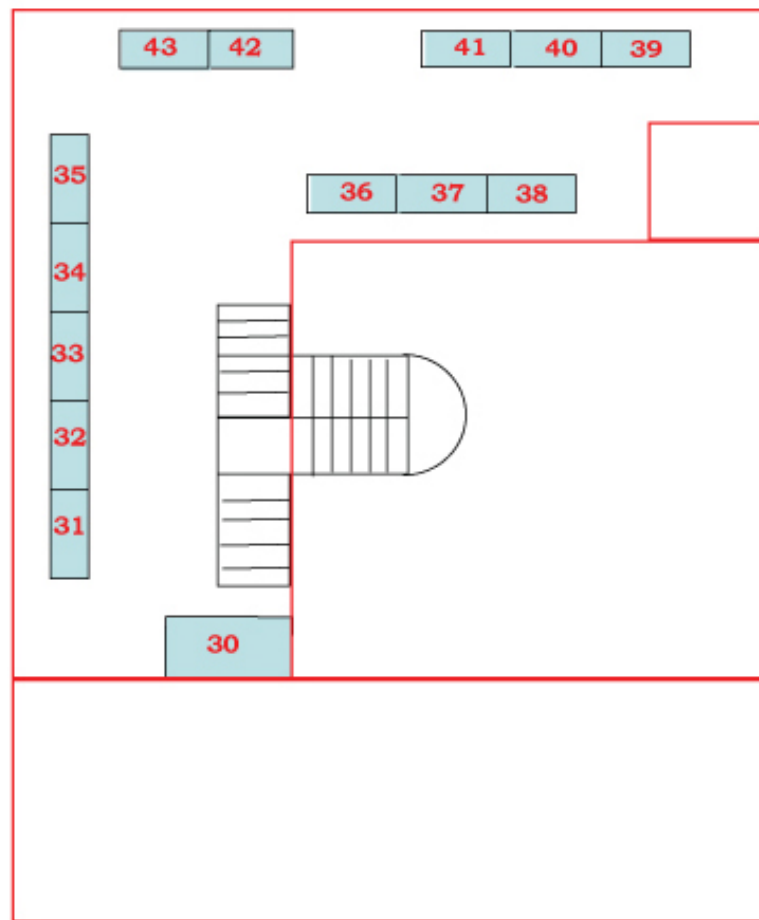

PLEASE SEE BACK OF THIS PAGE FOR PARTICIPANTS ON  
CMM/BLL LOBBY - LOWER